

# WitGood Intelligent Weighing System

## Installation Instructure

### Tools List

No.	Tool Name	Unit	Quantity	Remarks
1	Cutter	pc	1	Cut the tower column
2	Electric Hammer	pc	1	Drill holes for expansion screws, drill concrete piers
3	Electric Drill	pc	1	Drill holes in the tower column
4	Power Tool	pc	1	Screw disassembly and fixing
5	Wrench Socket	set	1	Screw disassembly and fixing
6	Measuring Tool	pc	1	Measure cutting height and draw lines
7	Hand Tool	set	1	Wrench (30-32 open end, 22 box end), hammer, wire stripper, diagonal pliers
8	Welding Machine	set	1	For flange plate welding and fixing
9	Hydraulic Jack (5T)	pc	1	For supporting the tower during the installation of the weighing sensor

### Auxiliary Materials List (Quantity as needed)

No.	Name	Specification	Unit	Remarks
1	Corrugated Tube	Φ32	m	For sensor cable routing
2	PVC Pipe	Φ20	m	For equipment power cable routing
3	PVC Elbow	Φ20	pc	For equipment power cable routing
4	Pipe Clamp	Φ20	pc	For equipment power cable routing
5	Power Cable	2*1.0 m <sup>2</sup>	m	For powering the fixed electrical box, equipment uses 220V AC
6	Expansion Screw	M12*120	pc	For fixing the sensor base, usually requires 4 screws per base, select screw specifications as needed
7	Cable Tie	4*250	pack	For fixing corrugated tubes and cables
8	Electrical Tape	-	roll	For sealing power interfaces

### Pre-installation Precautions

Ensure that the load cells and weighing controllers have matching numbers before installation to avoid issues during later use. Matching numbers indicate the same set of equipment.

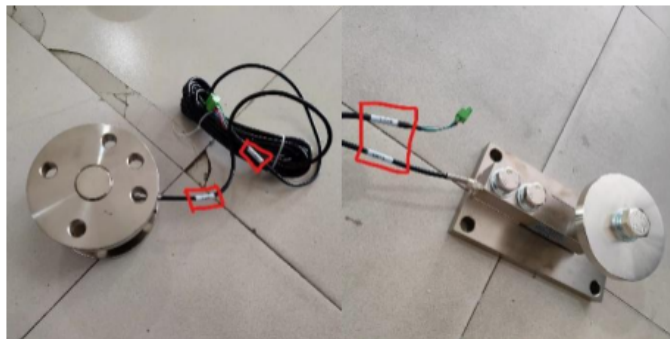

## Installation Programme

Step 1: Remove the base plate (for modifying old facilities)



Step 2: Mark the lines (for modifying old facilities)



Step 3: Cut the support legs (for modifying old facilities)



Step 4: Clean the floor



Step 5: Drill holes for the support legs



Step 6: Install the base plate + sensor





Refer to the video for specific operations. Based on site conditions, after fixing the weighing controller, connect the sensor cables to the weighing controller as per the numbers indicated in the diagram.



## Installation Completed



## Equipment Commissioning

After connecting the power, please perform equipment commissioning first. Please refer to other documents and videos, or contact customer service.

[info@swttech.com](mailto:info@swttech.com)